

Shops on Valencia – Tucson, AZ



UNITED DEVELOPMENT COMPANY



CHRISTIFULLI

Project Photos



Neither this presentation nor any of its content is an offer or a solicitation to invest in any security and does not form part of any solicitation or offering that may exist now or in the future. Security offerings, if any, will only be made pursuant to exemptions from registration requirements set out in applicable securities laws.



Location Map



This development is located at the southwest corner of Valencia and Headley in the southwestern part of Tucson, AZ. The location is roughly 10 miles from downtown Tucson and the University of Arizona. It is less than 2 miles off of I-19, which generates 60,000 cars a day. There are more than 117,500 daytime employees within a 5-mile radius. The Shops on Valencia are just west of a new Fry's, Lowe's and Walmart Supercenter. The project is approximately 11.3 acres and is comprised of 7 retail pads. Users include: IHOP, Risas Dental and Braces, and Dutch Brothers Coffee.

Site Plan

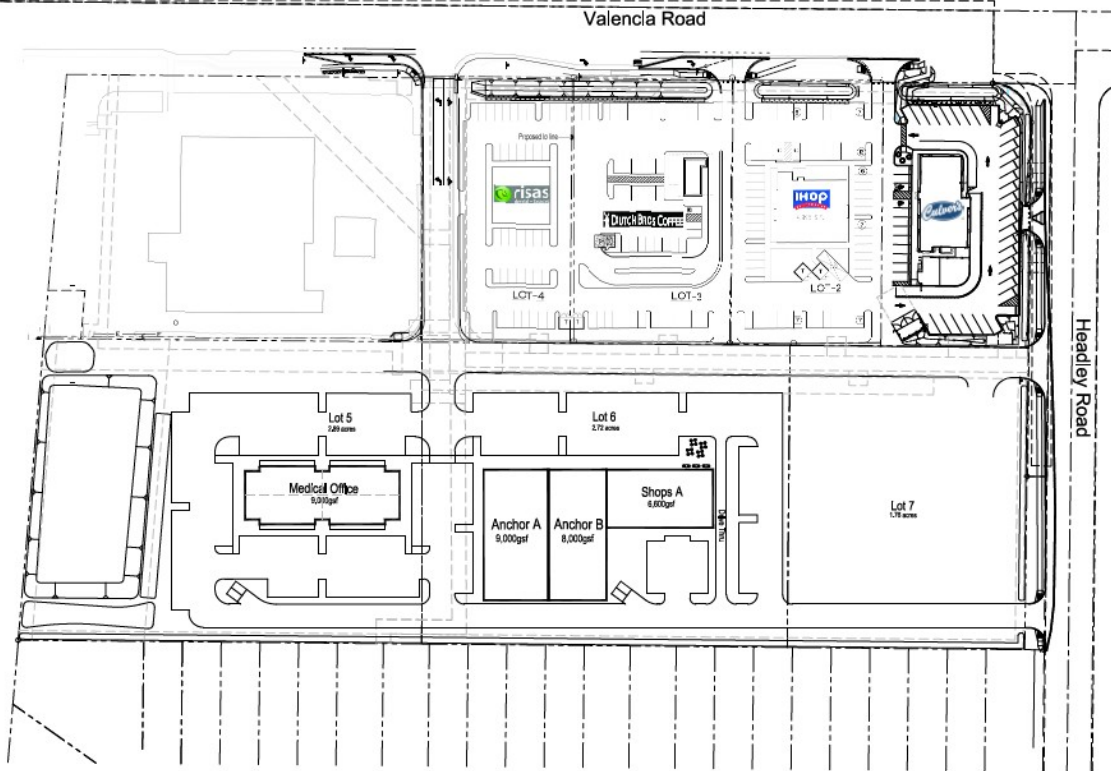

Option Ten(A)

Site Area: 5.61 acres
 Total Building Area: 32,600gsf
 Parking Provided: 200 spaces (6.14 : 1000sf)

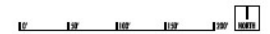

19109 10-3-19

CHRISTIFULLI VALENCIA- Tucson, Arizona

Notice of IP Rights: 2018 DAVIS. THESE DESIGNS ARE THE EXCLUSIVE PROPERTY OF DAVIS. NO USE OR REPRODUCTION IS PERMITTED WITHOUT THE EXPRESS WRITTEN PERMISSION OF DAVIS.